

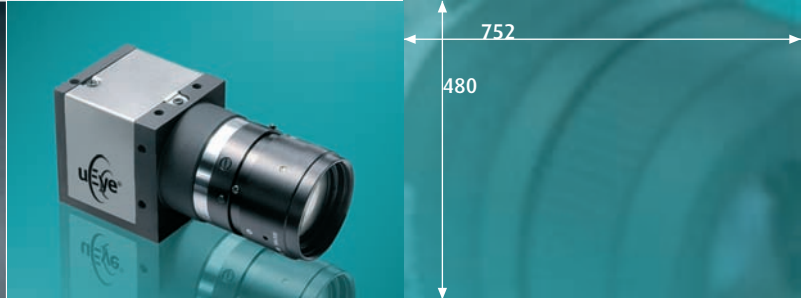

iDS



uEye[®] UI-1220-C/M

WVGA Camera with 1/3" CMOS Global Shutter Sensor

uEye® UI-1220-M / UI-1220-C



The uEye® Family

uEye® stands for a family of extremely compact, low-cost cameras for professional use in automation, quality assurance, security technology and non-industrial applications. Through the use of the widespread USB technology, the cameras can be interfaced with a vast variety of systems without any problems.

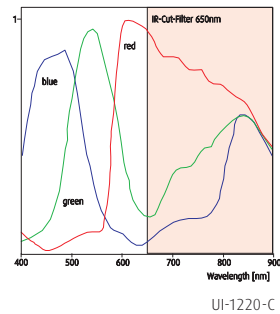
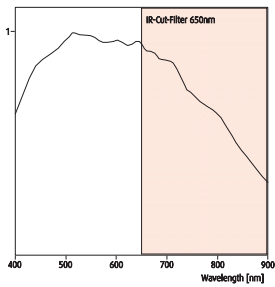

Sensor characteristics

UI-1220-M

UI-1220-C

Screw-mounted Micro Sub-D connector for USB, Trigger and Digital-Out

Conventional USB Mini-B connector

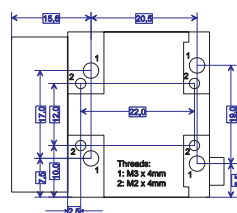
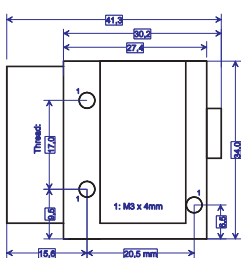
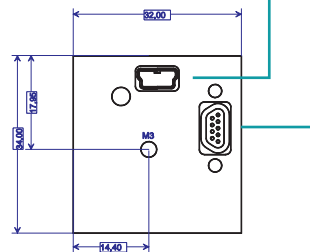
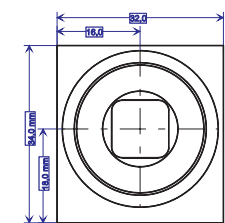

Dimensions: uEye® CMOS models without memory.
The depth of the memory models housing is +7mm

The characteristics at a glance

Interface	USB 2.0
Sensor Technology	CMOS
Model description (color)	UI-1220-C
Model description (Mono)	UI-1220-M
Resolution (h x v)	752 x 480
Resolution Category / Pixel Class	WVGA
Sensor size	1/3"
Shutter	Global
max. fps in Freerun Mode at full resolution	87 fps
max. fps in SW Trigger Mode at 1 ms exposure	78 fps
Exposuretime in Freerun Mode	80 µs - 5,5 s
Exposuretime in Trigger Mode	80 µs - 5,5 s
AOI Modes	H ² + V ²
AOI with 320 x 240 Pixels (CIF)	215 fps
Subsampling Modes	-
Subsampling Factors	-
Resolution, fps	-
Binning Modes	H + V ² (Mono)
Binning Method	H + V: Average
Binning Factors	x2, x4
Resolution, fps	368 x 240, 162 fps 176 x 120, 286 fps
Mono: Maximum Gain	4x
Farbe: Maximum Gain RGB/Master	5x (SW)/4x
Additional Gain Boost with Factor	1,6x
Sensor Model	MT9V032
Pixel Clock	5 - 40 MHz
Pixelpitch in µm	6,0
Full Well Capacity	30.000 e-
Optical Size	4,51 x 2,88 mm
Aspect Ratio	14:9
Exact Real Diagonal	5,4 mm, 1/3,0"
Current consumption at 5 V	100 - 130 mA

² = Use increases frame rate

In scope of delivery:

Powerful, easy to handle uEye SDK
uEye Demo and Programexamples executable and Source Code.
TWAIN, Active-X and Direct Show (WDM) drivers
Interfaces for Activision Tools, Common Vision Blox, HALCON, LabVIEW and Neurocheck

Driver for Windows 2000, XP, VISTA and Linux - WindowsCE on request

